

pelham road

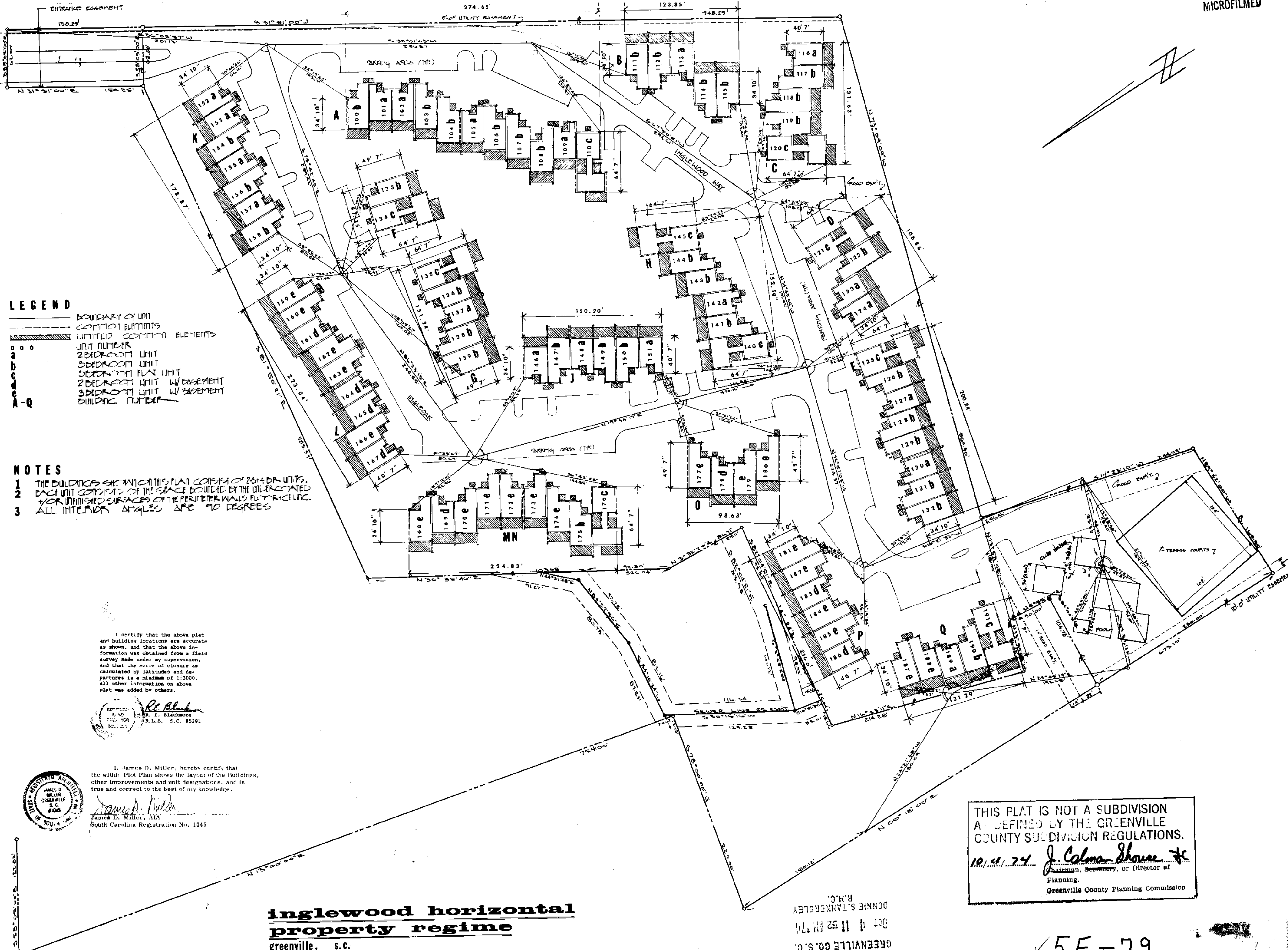

LEGEND

- BOUNDARY OF UNIT
- - - COMMON ELEMENTS
- ▨ LIMITED COMMON ELEMENTS
- 000 UNIT NUMBER
- 2 BEDROOM UNIT
- 3 BEDROOM UNIT
- 3 BEDROOM PLAN UNIT
- 2 BEDROOM UNIT W/ BASEMENT
- 3 BEDROOM UNIT W/ BASEMENT
- BUILDING NUMBER

NOTES

- 1 THE BUILDINGS SHOWN ON THIS PLAN CONSIST OF 204 BK UNITS.
- 2 EACH UNIT CONSISTS OF THE SPACE BOUNDED BY THE UTILIZED SURFACES OF THE PERIMETER WALLS, FLOORING, CEILING, AND FINISHES.
- 3 ALL INTERIOR ANGLES ARE 90 DEGREES

I certify that the above plat and building locations are accurate as shown, and that the above information was obtained from a field survey made under my supervision, and that the error of closure as calculated by latitudes and departures is a minimum of 1:3000. All other information on above plat was added by others.

R. E. Blackmore
 R. E. Blackmore
 Surveyor
 R.L.S. S.C. #5291



I, James D. Miller, hereby certify that the within Plot Plan shows the layout of the buildings, other improvements and unit designations, and is true and correct to the best of my knowledge.

James D. Miller
 James D. Miller, AIA
 South Carolina Registration No. 1045

**inglewood horizontal
 property regime**
 greenville, s.c.



THIS PLAT IS NOT A SUBDIVISION AS DEFINED BY THE GREENVILLE COUNTY SUBDIVISION REGULATIONS.

10/11/79 *J. Colman Shouse*
 Chairman, Secretary, or Director of Planning
 Greenville County Planning Commission

FILED
 GREENVILLE CO. S.C.
 OCT 4 11 52 AM '79
 R.M.C.
 DONNIE S. TANKERSLEY

5F-79

RECORDING FEE
 PAID \$ 3.00